

# The F tool™ by Andrew Zajac

harp.andrewzajac.ca

The F tool can correct air leaks caused by a reed plate that is not perfectly flat. Use the reference bar with or without a 0.001" feeler gauge to identify leaks.

Please watch the instruction video and download the written instructions here:  
<http://harp.andrewzajac.ca/tools/TheFTool>

## Guidelines

- It's a good idea to practice on scrap harps.
- If you have trouble seeing air leaks, try adjusting the light in your work area. It's very important to have a clear view of the leak you are fixing before you use the F tool. Use a thin feeler gauge to probe for an air space if you prefer.
- Remember to always apply light pressure.
- There is a learning curve to straightening reed plates.
- Try not to overshoot the mark.
- Use the F Tool™ on both the blow and draw reed plates.

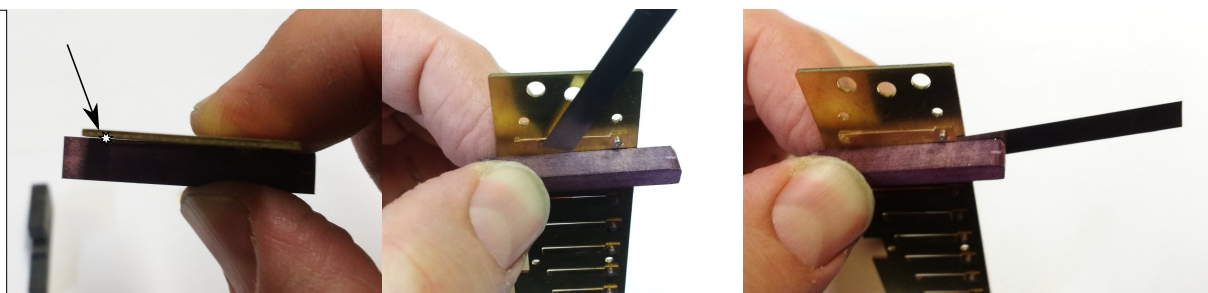
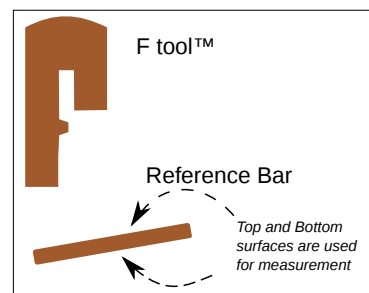
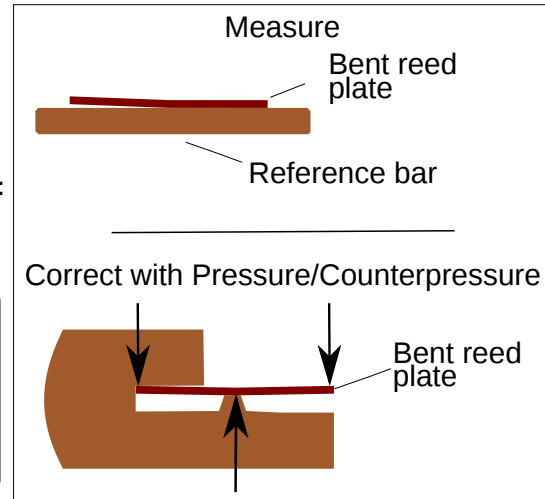

## The F tool™ INSTRUCTIONS

harp.andrewzajac.ca

- 1. Measure:** Use the Reference bar to look for surfaces not in contact with the reed plate. If you have trouble seeing things up close you can probe around with a 0.001" shim.

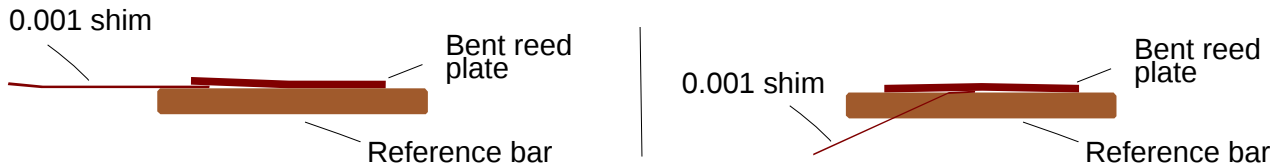

- 2. Correct with Pressure/Counterpressure.** Don't apply too much force! For very small corrections, use your fingers instead of pliers.

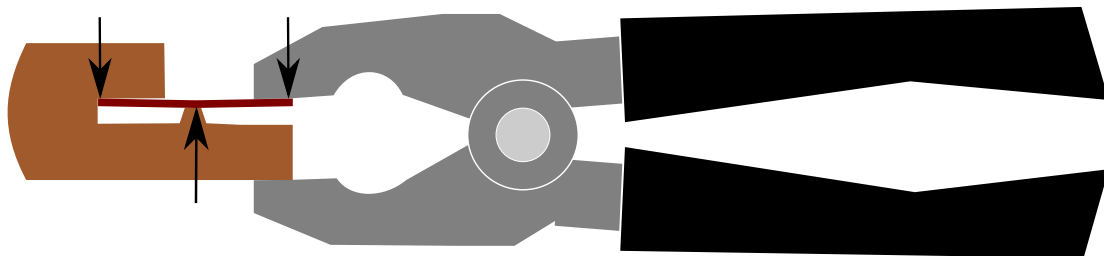

- 3. Check again.** If you overdid it and created a bow in the opposite direction, flip the plate around and correct it with the F tool and pliers (or your fingers). You usually only need a very slight amount of force to reverse. Check and repeat as needed.

- 4. Repeat** the same for every space down the reed plate.

- 5. Use the F tool and Reference bar to check the draw plate** as well as the blow plate..

## FREE 0.001" SHIMS!

Cut open a *Sensor-Matic* tag and you will find one or two perfect shims inside!

